



The Phoenix, Barrett Street,
Marylebone, W1U

£750 Per Week,

NAPIER WATT

T: 0207 935 0011
E: enquiries@napierwatt.co.uk
W: napierwatt.co.uk

35 Berkeley Square, Mayfair, London, W1J 5BF







Description

An exceptionally spacious, larger than average (863 sqft/ 80 sqm) one bedroom apartment set on the first floor of this sought-after purpose built block located within 50m of Selfridges.

This stunning apartment is offered in excellent decorative condition, having been recently refurbished and decorated. It benefits from a particularly spacious 25ft, bright and airy reception room, a large, double bedroom with ample storage and ensuite bathroom and separate guest WC.

The Phoenix is uniquely positioned within 50m of Selfridges and 100 m of Oxford Street, it has a day porter, cctv and lifts. Parking is available by separate negotiation.

Westminster council Tax band G

Key Features

- DAY PORTER
- 50 M SELFRIDGES
- LONG LET
- PARKING AVAILABLE BY SEP NEG
- LIFTS
- EXCELLENT CONDITION
- 100M OXFORD STREET
- ENSUITE BEDROOM

Terms

Fees & Charges: Tenancies exceeding £100,000 Per annum £480 inc VAT, Tenancies where a company is a tenant £480 Inc VAT.

The Phoenix

Approx. Gross Internal Area 863 Sq Ft - 80.18 Sq M

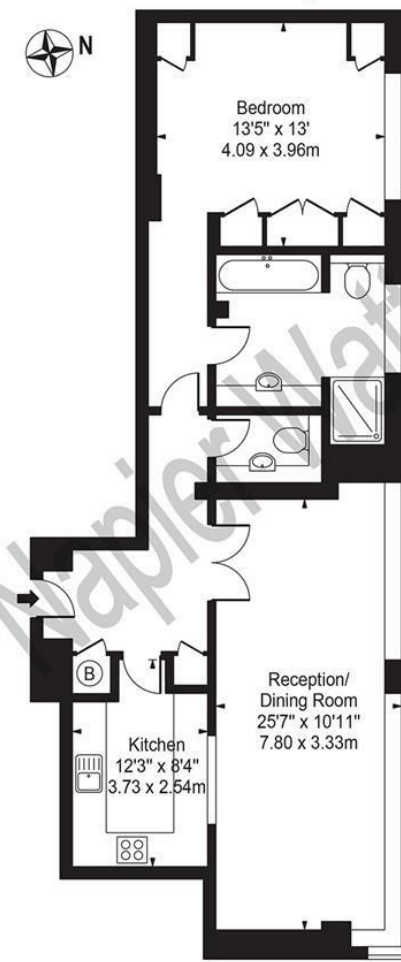

First Floor

For Illustration Purposes Only - Not To Scale

This floor plan should be used as a general outline for guidance only and does not constitute in whole or in part an offer or contract. Any intending purchaser or lessee should satisfy themselves by inspection, searches, enquiries and full survey as to the correctness of each statement. Any areas, measurements or distances quoted are approximate and should not be used to value a property or be the basis of any sale or let.

IMPORTANT: We would inform prospective purchasers that these sales particulars have been prepared as a general guide only. A detailed survey has not been carried out, nor the services, appliances and fittings tested. Room sizes should not be relied upon for furnishing purposes and are approximate. If floor plans are included, they are for guidance only and illustration purposes only and may not be to scale. If there are any important matters likely to affect your decision to buy, please contact us before viewing the property.